

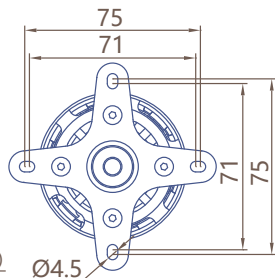

Dimensions

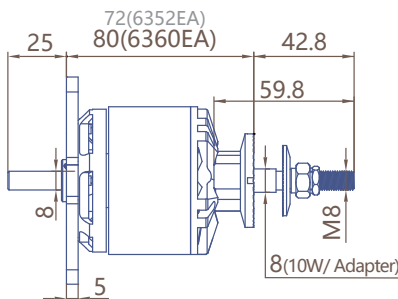
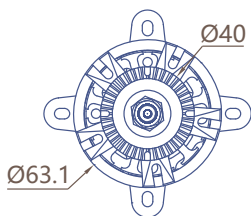
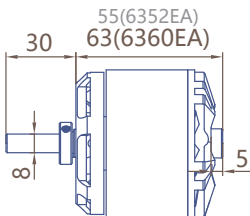
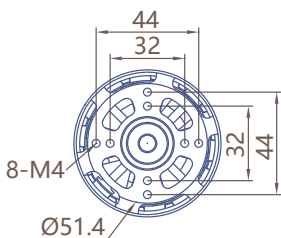

Specification

EA V3 Series	XM6360EA-11	XM6360EA-19	XM6360EA-22
SKU(商品编码)	51870	51871	51872
KV(KV值)	380	220	190
Stator Dimensions(定子尺寸)	5330	5330	5330
Diameter of Shaft(MM)(轴径)	8.0	8.0	8.0
Ri(mOhm)(电阻)	9.8	28	36
I _o @10V (A)(空载电流)	2.6	1.2	1.0
Weight(g)(重量)	650	635	640
Burst Current (15S)[A](峰值电流)	130	95	82
Power(15S)[W](峰值功率)	3120	3800	3936
Torque [N*M](峰值扭矩)	4.08	5.15	5.15
Recommended ESC (推荐调速器)	SUMMIT 120	SUMMIT 120HV	SUMMIT 120HV
Propeller(螺旋桨)	6S: 20x12E, 21x13E, 22x10E	10S: 20.5x12WE, 21x13E 12S: 19x10E, 20x8E, 20x10E	10S: 22x12E, 23x10E 12S: 20.5x12WE, 22x10E
Memo (备注)	160E, .140-.160 2-stroke Up to .200 4st		